

Top Entry Combination Ball Valve



Applicable Standards:

DESIGN & MANUFACTURE CONFORM WITH : API 6D/ISO 14313, ASME B16.34

CONNECTION DIMENSION CONFORMS WITH : ASME B16.5, DN EN 1092

FIRE RESISTANCE DESIGN CONFORMS WITH : API 607/ISO 10497

INSPECTION & TEST CONFORMS WITH : API 6D, ISO 5208, API 598

MATERIAL CONFORMS WITH : ISO 15156

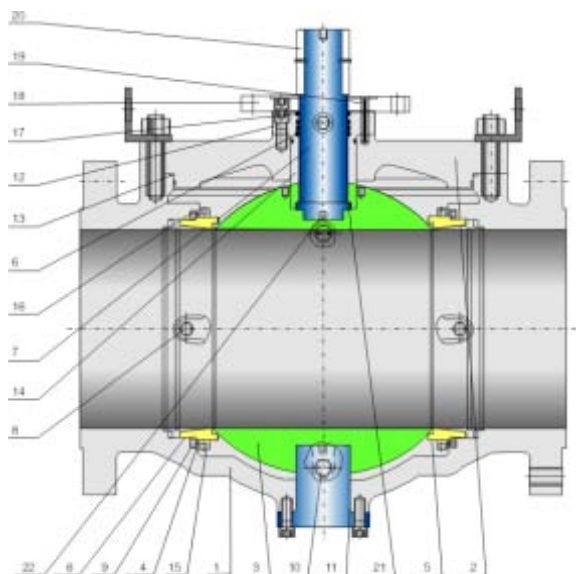

NO	PART NAME	NO	PART NAME
1	Body	12	Screw
2	Bonnet	13	Gasket
3	Ball	14	Support Cover
4	Seat	15	Seat Retainer Ring
5	Sealing Ring	16	Spring Support Cover
6	O-Ring	17	Packing
7	Stem	18	Connected Flange
8	Grease Injection Valve	19	Pin
9	Spring	20	Flat Key
10	Blow-Down Valve	21	Stem Gasket
11	Lubricating Bearing	22	Antistatic Spring

Features and Application:

This product is a new type top entry combination ball valve, the seat can be installed and move around the body. Through the thread, the outer margin of the seat connected to the retainer ring. There is spring on the support cover, which installed on the valve body, and the retainer ring can compress spring. The fabrication holes are on the outer margin of the seat and the retainer ring. This new type product adopts total body design, the compensation can be automatically, the possibility of leakage is small, safety in use, vibrate resistance, and double seal. The ball is installed from the top part, so can finish the maintenance without removing the pipe, it is very convenient.

Materials of parts

Body	WCB/LCB/CF8M/CF8/CF3M/CF3/WC6/WC9/CD3MN
Bonnet	WCB/LCB/CF8M/CF8/CF3M/CF3/WC6/WC9/CD4MN
Ball	A105+ENP/LF2+ENP/F304/F316/F304L/F316L/F51
Seat	A105+ENP/LF2+ENP/F304/F316/F304L/F316L/F51
Stem	A105+ENP/LF2+ENP/F304/F316/F304L/F316L/F51
Seat ring	PTFE/MYLON/PEEK/TEFLON
O-ring	VITON/NBR
Bolt	B7M/B8M/L7M/B16M
Support cover	A105+ENP/LF2+ENP/F304/F316/F304L/F316L/F51
Spring	17-4PH/17-7PH/Inconel
Bearing	304+PTFE/316+PTFE
Gasket	Flexible graphite+PTFE

Materials could be choosed according to customers' requirement & working condition.

Top Entry Combination Ball Valve 150Lb/300Lb



Applicable Standards:

DESIGN & MANUFACTURE CONFORM WITH : API 6D/ISO 14313, ASME B16.34

CONNECTION DIMENSION CONFORMS WITH : ASME B16.5, DN EN 1092

FIRE RESISTANCE DESIGN CONFORMS WITH : API 607/ISO 10497

INSPECTION & TEST CONFORMS WITH : API 6D, ISO 5208, API 598

MATERIAL CONFORMS WITH : ISO 15156

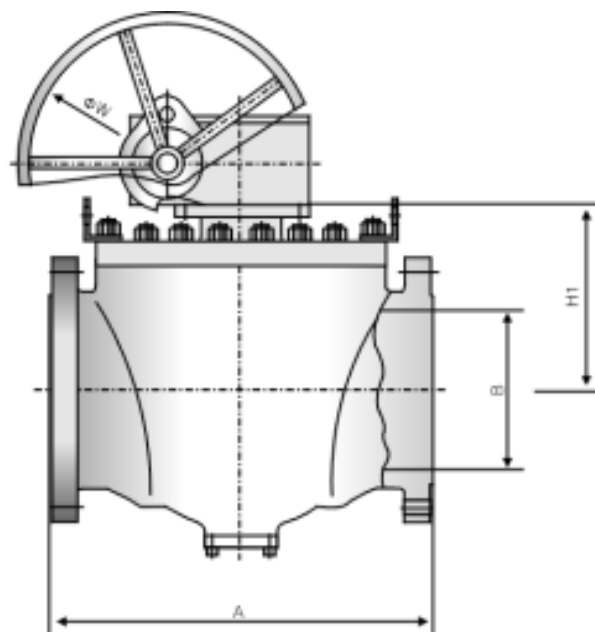
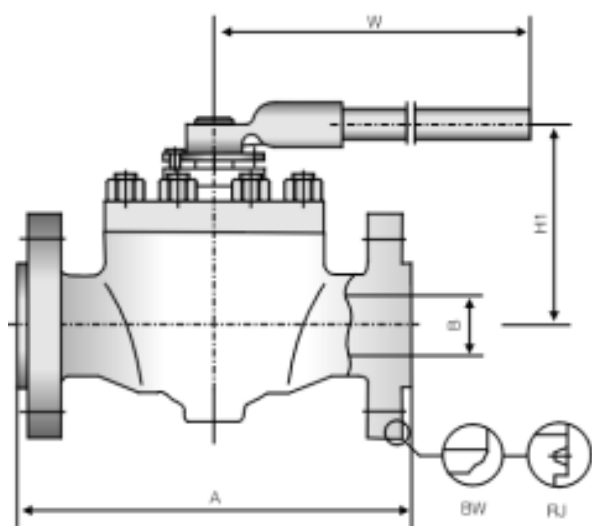

Dimensional datas

NPS inch	DN	A mm	B mm	H1 mm	W mm	WT kg	T N.m	NPS inch	DN	A mm	B mm	H1 mm	W mm	WT kg	T N.m
ANSI Class 150Lb															
2	50	292	51	207	300	30	50	14	350	889	334	455	600	760	2426
3	80	356	76	223	400	57	65	16	400	991	385	460	600	1100	3016
4	100	432	100	280	450	100	151	18	450	1092	436	503	600	1512	4574
6	150	559	150	275	460	215	320	20	500	1194	487	560	700	1930	6016
8	200	660	201	321	460	407	1020	24	600	1397	589	610	700	3200	9750
10	250	787	252	355	600	560	1085	28	700	1549	684	730	700	4600	14540
12	300	838	303	470	600	710	1562	30	750	1651	735	800	760	5630	18005

Dimensional datas

NPS inch	DN	A mm	B mm	H1 mm	W mm	WT kg	T N.m	NPS inch	DN	A mm	B mm	H1 mm	W mm	WT kg	T N.m
ANSI Class 300Lb															
2	50	292	51	211	300	36	86	14	350	889	334	460	600	766	3800
3	80	356	76	226	500	63	110	16	400	991	385	480	600	1106	5376
4	100	432	100	286	550	106	270	18	450	1092	436	508	600	1519	8000
6	150	559	150	282	460	221	500	20	500	1194	487	565	700	2010	10610
8	200	660	201	325	460	412	1620	24	600	1397	589	617	760	3208	17280
10	250	787	252	360	600	566	1824	28	700	1549	684	678	760	4607	25102
12	300	838	303	420	600	715	2632	30	750	1651	735	738	760	5638	31664

Top Entry Combination Ball Valve 600Lb/900Lb/1500Lb



Applicable Standards:

DESIGN & MANUFACTURE CONFORM WITH : API 6D/ISO 14313, ASME B16.34

CONNECTION DIMENSION CONFORMS WITH : ASME B16.5, DN EN 1092

FIRE RESISTANCE DESIGN CONFORMS WITH : API 607/ISO 10497

INSPECTION & TEST CONFORMS WITH : API 6D, ISO 5208, API 598

MATERIAL CONFORMS WITH : ISO 15156

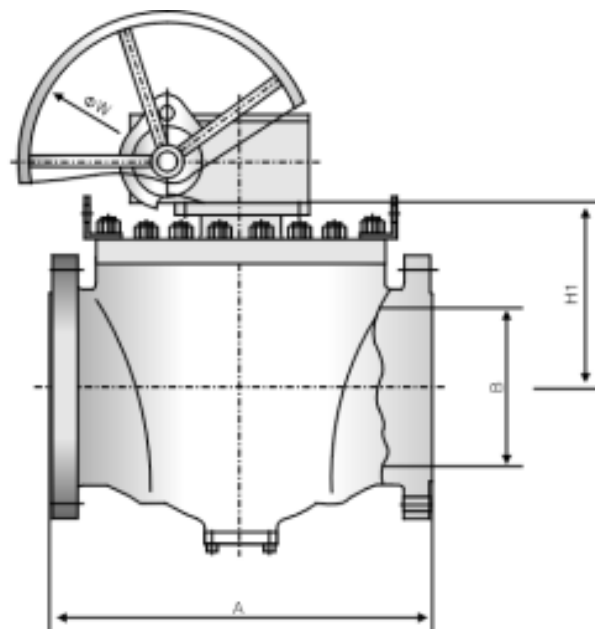
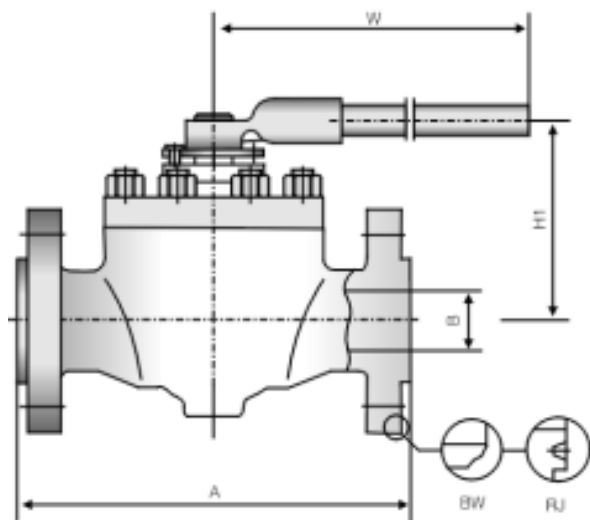

Dimensional datas

NPS inch	DN	A mm	B mm	H1 mm	W mm	WT kg	T N.m	NPS inch	DN	A mm	B mm	H1 mm	W mm	WT kg	T N.m
ANSI Class 600Lb															
2	50	292	51	215	500	41	148	14	350	889	334	465	700	770	7255
3	80	356	76	232	600	67	200	16	400	991	385	470	700	1112	9174
4	100	432	100	294	600	110	460	18	450	1092	436	512	760	1523	13520
6	150	559	150	287	600	226	908	20	500	1194	487	570	760	1940	18034
8	200	660	201	324	600	417	2560	24	600	1397	589	622	760	3213	29512
10	250	787	252	365	600	570	3048	28	700	1549	684	742	760	4612	42264
12	300	838	303	480	700	720	4300	30	750	1651	735	817	850	5640	58864

Dimensional datas

NPS inch	DN	A mm	B mm	H1 mm	W mm	WT kg	T N.m	NPS inch	DN	A mm	B mm	H1 mm	W mm	WT kg	T N.m
ANSI Class 900Lb															
2	50	368	49	212	650	52	208	12	300	965	303	507	700	1300	6000
3	80	381	74	227	700	110	280	14	350	1029	322	520	700	1695	10220
4	100	457	100	277	800	200	650	16	400	1130	373	538	760	2560	12968
6	150	610	150	283	600	430	1298	18	450	1219	423	580	760	3400	19054
8	200	737	201	334	600	800	3596	20	500	1321	471	625	760	4400	25452
10	250	838	252	380	600	1000	4306	24	600	1549	589	690	850	7200	38655

Dimensional datas

NPS	DN	A	B	H1	W	WT	T	NPS	DN	A	B	H1	W	WT	T
ANSI Class 1500Lb															
2	50	368	49	212	600	56	330	10	250	991	239	398	700	1438	6720
3	80	470	74	236	600	153	440	12	300	1130	287	520	700	2017	14520
4	100	546	100	295	600	278	1034	14	350	1257	315	560	760	2612	32600
6	150	705	144	303	600	600	2084	16	400	1384	360	570	760	3890	49650
8	200	832	192	354	600	1100	5496	18	450	1477	405	592	760	5100	66350